

1
2
3 June 28, 1979

Introduced by: GARY GRANT

4 Proposed Ordinance No. 79-960

5
6 ORDINANCE NO. 4434

7 AN ORDINANCE approving an amendment to the Water
8 District No. 108 Water Comprehensive Plan for an
9 area known as Maple Valley Ranches.

10 PREAMBLE:

11 On May 23, 1979, Water District 108 adopted Resolution
12 No. 1384 providing for an amendment to their Water
13 Comprehensive Plan.

14 These additions and betterments are exempt from the State
15 Environmental Policy Act.

16 The Utilities Technical Review Committee reviewed the pro-
17 posed amendment as required by KCC 13.24 and Ordinance
18 No. 4146 and on June 27, 1979, recommended their approval.

19 As required by Ordinance No. 4146, Section 1.2, the Util-
20 ities Technical Review Committee has found that the proposed
21 facilities lie within the boundaries of the District and
22 that the cost and financing of the proposed facilities can
23 be fully funded without new subdivision or zoning change.

24 BE IT ORDAINED BY THE COUNCIL OF KING COUNTY:

25 SECTION 1. The amendment to the Water District 108 Com-
26 prehensive Plan as adopted by District Resolution No. 1384
27 (attached) is found to be consistent with the provisions of
28 Ordinance No. 4146, and is hereby approved.

29 INTRODUCED AND READ for the first time this 16th day of
30 July, 1979.

31 PASSED this 6th day of August, 1979.

KING COUNTY COUNCIL
KING COUNTY, WASHINGTON

Reley Chow
Chairman

ATTEST:

Louise M. Quinn
Deputy Clerk of the Council

APPROVED this 15th day of August, 1979.

[Signature]
King County Executive

WATER DISTRICT NO. 108 OF KING COUNTY, WASHINGTON

RESOLUTION NO. 1384

A RESOLUTION of the Board of Commissioners of Water District No. 108 of King County, Washington amending Resolution No. 18 adopted February 16, 1961, as thereafter amended, providing additions and betterments to the original Comprehensive Scheme or Plan of Water Supply System to serve a portion of an annexed area (Annexation No. 12-4); estimating the costs thereof and providing a method of financing said cost by the issuance of Water Revenue Bonds in the principal sum of \$100,000.00 for the purpose of providing funds to pay the cost of said additions and betterments.

WHEREAS a Comprehensive Scheme or Plan of Water Supply System of the District was adopted by Resolution No. 18 of the Board of Commissioners of this District on February 16, 1961, and was duly ratified by the electors of the District at an election held May 16, 1961; and was thereafter amended by Resolution No. 106 adopted May 12, 1965, and thereafter by Resolution Nos. 140, 148, 167, 480, 509, 524, 573, 733, 750, 752, 753, 758, 764, 974, 993, 1114, 1181, 1185, 1272, 1326, 1381 and 1382 in respect to such water supply system; and

WHEREAS the area described on attached Exhibit A, made a part hereof by this reference as though set forth herein in full, was annexed to the District (Annexation No. 12-4) by Resolution No. 1024 adopted June 9, 1976; and

WHEREAS the Board of Water Commissioners has determined that it is in the best interests of the District that improvements and betterments be made to the original Comprehensive Scheme or Plan for Water Supply System as heretofore amended to provide water service to the annexed area; and the Board of Water Commissioners have, as required by law, investigated, determined and selected a plan for installing such additions and betterments and all appurtenances thereto; and have determined the method of distributing the cost and expense thereof against the District and against a Utility Local Improvement District, if formed within the District, for the purposes authorized by law, and have determined the amount of the cost and expenses thereof to be paid from Water Revenue Bonds as provided by law, now, therefore,

BE IT RESOLVED that the following plan or scheme for additions and betterments for the water supply system of the District to provide water supply and distribution facilities and all appurtenances to the proposed service area described on Exhibit A is hereby adopted, and Resolution No. 18 heretofore adopted on February 16, 1961, and as heretofore amended, is further amended as follows:

Section 1. Water System

A. Water Supply.

1. Water supply shall be from the existing water supply system of the District; and the water distribution system as hereafter described shall be connected to the present water supply system at the location as described on attached Exhibit C.

B. Storage Facilities.

..... (none needed).....

C. Distribution Mains.

1. The District shall acquire, construct, install or otherwise provide
1.

COPY

an 8-inch distribution main in the locations as set forth on attached Exhibit C made a part hereof by this reference as though set forth herein in full.

2. Unplatted Area. All the area not now platted and within the boundaries described on Exhibit A shall be served in the manner described in Resolution No. 18 of Water District No. 108 of King County, Washington, after the area is platted and extensions and additions to the water distribution system shall be acquired, constructed or otherwise provided, on, in, along and over the newly-platted streets and ways in said unplatted areas.

3. Fire Hydrants. The District shall acquire, construct or otherwise provide fire hydrants throughout the area described in Exhibit A as required for Zone 1 classification for fire protection in a populated area and where feasible.

4. Appurtenances. Said mains, lines, and laterals shall be installed with all valves, fittings and other necessary auxiliary equipment commonly used or required for a complete water supply system.

D. Engineers' Plans and Specifications and Changes.

The above-described Plan or Scheme for additions and betterments to the Comprehensive Plan or Scheme for a water supply for the District is all as more particularly set forth in maps, plans and specifications prepared by Richard C. T. Li, Inc., Consulting Engineers, Seattle, Washington, and to be filed with the Commissioners of this District.

The above-described improvements shall be subject to such changes as to details of pipe sizes and locations or other details of said plan of improvement not affecting the service to be provided thereby either prior to or during the actual course of construction which shall be found necessary and desirable and so long as the same do not affect the main general features of said plans of improvement, nor substantially affect nor change the intent of said plans or improvements as hereinabove set forth.

E. Estimated Cost. The estimated cost of the construction and installation of the above-described plan or scheme of additions or betterments, including all general engineering, legal and other expenses incidental thereto, is hereby fixed as near as may be as the sum of \$100,000.00, which sum may be provided from the sale of Water Revenue Bonds of the District, for which provision is hereinafter made.

F. Facilities Installed by Property Owners.

It is a part of the plan of additions and betterments herein set forth that the provisions of Para. B-6 of Section I of the Comprehensive Plan set forth in Resolution No. 18 shall be and by this reference is made a part hereof as though set forth herein in full.

G. Acquisition of Property, Rights-of-Ways, Easements, etc..

It is a part of the plan of additions and betterments that the District shall acquire all property, rights-of-way, easements, franchises and other rights necessary for the acquisition, construction and installation of said improvements and shall enter into such contracts as may be necessary to carry out the Comprehensive Plan or Scheme of Water Supply for the District as hereby amended.

Section 2. Financing of Additions and Betterments to the Comprehensive Plan.

It is a part of this Plan or Scheme of additions and betterments that the Water Revenue Bonds of the District may be issued in the principal amount of not to exceed \$100,000.00. Said bonds shall bear interest at a rate to be established by Resolution of the Board of Commissioners, payable semi-annually, and shall mature in various amounts each year and from two (2) to

not more than twenty (20) years from date of issue. Both the principal and interest of said bonds shall be paid from the gross revenues of the water system and all additions and betterments thereto and from assessments, if any, as hereinafter provided, the exact date, form, terms and maturity of said bonds shall be as hereinafter fixed by the Resolution of the Board of Commissioners.

It is further a part of said Plan or Scheme of additions and betterments herein provided for and authorized that where the owners of the property located within the District do not construct and install the water supply system or portion thereof, as herein otherwise provided for, in conjunction with the erection of various residences throughout the District, that all of the lands within the District that shall be specially benefitted by the construction and installation by the District of the Plan or Scheme of additions and/or betterments to the Comprehensive Plan or Scheme for a Water Supply System as hereinabove described and as herein authorized, may be included in one or more Utility Local Improvement Districts, and assessments shall be levied in said District or Districts in the amount to be fixed by the Board of Commissioners for each such District not to exceed \$100,000.00 for all such Districts and within the special benefits received. All of the assessments so levied in such Utility Local Improvement Districts shall be collected and paid into a Revenue Bond Redemption Fund heretofore created, to be applied solely in payment of the principal and interest of the Water Revenue Bonds for which provision is made hereunder. Levying, collecting and enforcement of all assessments in said Utility Local Improvement District shall be in the manner provided by law.

Section 3. Effective Date; Approvals

This amendment to the Comprehensive Scheme or Plan of Water Supply System of Water District No. 108 of King County, Washington shall be effective May 23, 1979, subject to the approval of the applicable governmental agencies as provided by law.

PASSED BY THE BOARD OF COMMISSIONERS OF WATER DISTRICT NO. 108 OF KING COUNTY, WASHINGTON at its regular meeting held May 23, 1979.

/s/ Walter M. Canter
President and Commissioner Walter M. Canter

/s/ George E. Lewis
Commissioner George E. Lewis

/s/ Virginia May
Commissioner Virginia May

ATTEST:

/s/ Virginia May
Secretary and Commissioner Virginia May

WATER SYSTEM COMPREHENSIVE PLAN AMENDMENT

EXHIBIT A

LEGAL DESCRIPTION OF AREA TO BE SERVED

That portion of the Southeast $\frac{1}{4}$ of Section 5, Township 22 North, Range 6 East, W.M., King County, Washington, that lies to the north of the City of Seattle Cedar River Pipe Line Right of Way.

208TH AVE

LEGEND

- EXISTING WATER LINE
- - - PROPOSED WATER LINE
- ⊕ FIRE HYDRANT
- AREA BOUNDARY

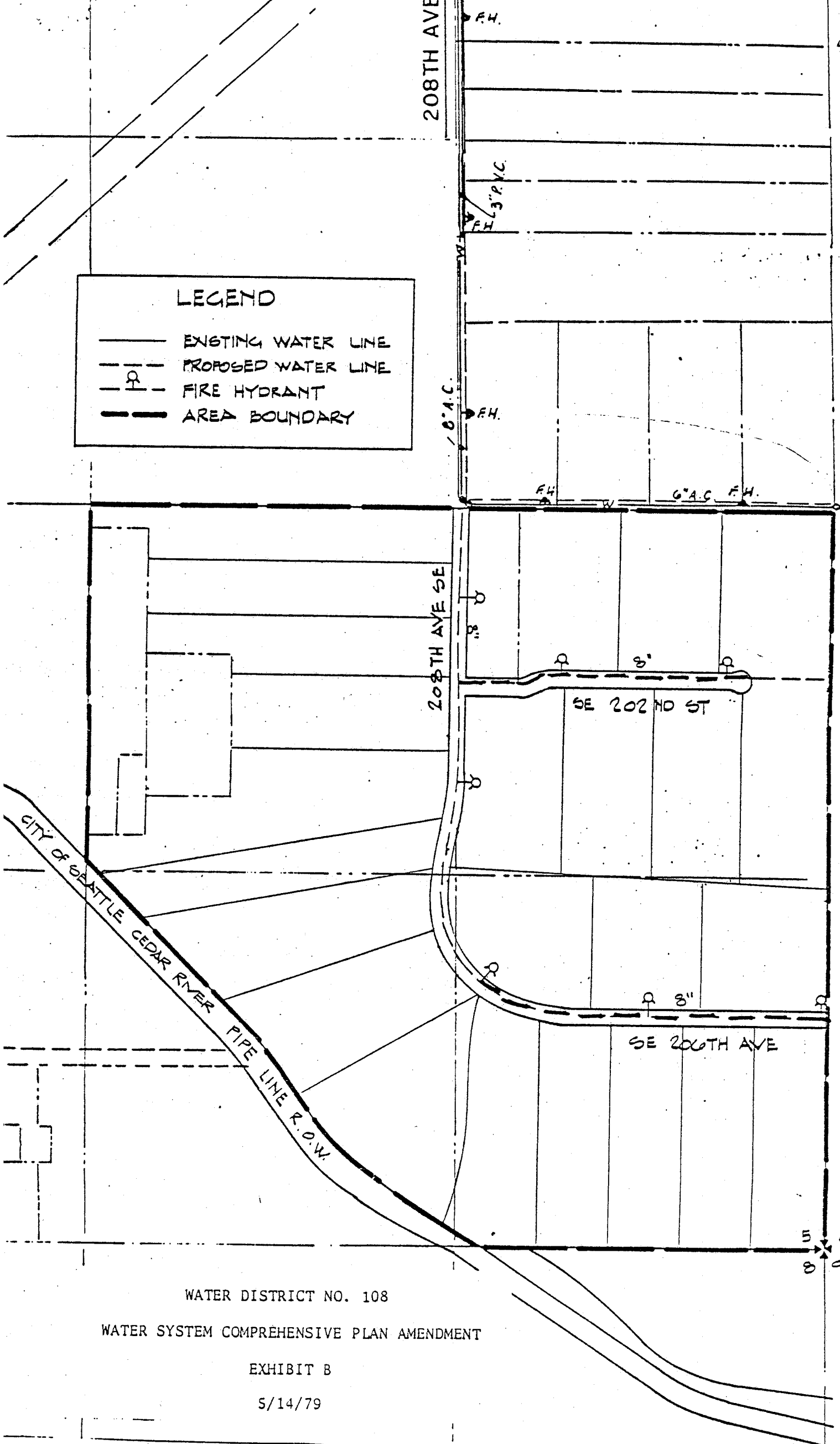

WATER DISTRICT NO. 108

WATER SYSTEM COMPREHENSIVE PLAN AMENDMENT

EXHIBIT B

5/14/79

Maple Valley Ranches

WATER SYSTEM COMPREHENSIVE PLAN AMENDMENT

EXHIBIT C

DESCRIPTION OF FACILITIES

Location	Dia.	Length	On	From	To
Sec. 5-22-6	8"	1720	208th Ave. SE	Approx. N line SE $\frac{1}{4}$ 5-22-6	SE 206th Ave.
Sec. 5-22-6	8"	1300	SE 206th Ave.	208th Ave. SE	Approx. E line SE $\frac{1}{4}$ 5-22-6
Sec. 5-22-6	8"	1320	SE 202nd St.	208th Ave. SE	Approx. E line SE $\frac{1}{4}$ 5-22-6

Estimated Cost \$100,000